

SEAWIND 1000

*Care free Syndicated Ownership
on Moreton Bay, Brisbane.
Fully Maintained and Managed.*

**\$39,900
per equity
share**

SW10169

**YACHT
SHARE**
Enjoy Life

0438 722 888

 on Performance,
 on Comfort

SEAWIND
CATAMARANS



“In even light airs the 1000 tacks every time – not all cats do” MODERN BOATING

With a distinctly Australian influence, enjoy wide open spaces in a huge cockpit with targa seats that surround the BBQ, all under protective shading. Sailing is taken seriously with a helm that works for the crew, featuring Seawind's trademark twin steering for outstanding visibility, fingertip controls

of all lines that are fed back to the cockpit where the crew remain protected from the elements making the Seawind 1000XL a fantastic shorthanded boat to sail.

The Seawind 1000XL is a versatile boat, ideal for chartering, weekend getaways, cruising the coastline or even ocean

passages, with many owners having sailed throughout the Pacific Ocean including to destinations such as New Zealand, Fiji, New Caledonia and more. Others have explored the American coastlines north to Canada & Alaska, and south to Mexico, Brazil and beyond.

“This is one strong boat” CLUB MARINE





“With extra waterline length, the Seawind 1000XL is agile and quick while still providing plenty in the way of creature comforts for its crew” CRUISING WORLD US

The Seawind 1000 has undergone several transforming refinements since it was originally launched and won Australian Sailboat of the Year. Since then around 200 boats have been built and are sailing all over the world. The latest exciting refinement is the addition of the XL Transom Extension, adding an additional 850mm in waterline length.

This improvement has resulted in an array of benefits including increased overall performance under sail & power and improved riding qualities. Large steps allow for easy boarding, while the open inboard profile accommodates boarding from a dinghy.





“You seem to flow around the Seawind from job to job and wherever you sit or put your feet, it feels just perfect” BOATING NZ

Moving around the Seawind 1000XL is easy and safe with large open deck areas and wide walkways onto the forward deck. The large opening saloon windows not only allow for excellent variable ventilation, they also allow the crew to communicate between the helm to the foredeck. This makes anchoring very efficient and trouble free. All of the best seating options are already considered including the helm, targa, cockpit and bow.

Get a different perspective from the bow seats or swim, snorkel and dive from the forward swim ladder. This is possible only due to the shallow draft of the Seawind 1000XL which even allows you to even nudge the boat onto a gentle beach for crew to disembark via this ladder.





“The design offers a heap of room, far more than is possible with a mono-hull of the same length.”

CLUB MARINE MAGAZINE

A combined saloon and cockpit provides unparalleled living space where it's needed most. Sheltered by a reinforced fibreglass hardtop, the Seawind 1000XL saloon ensures the crew are comfortable and protected from the elements while creating an amazing living platform complete with a large saloon table that converts into a king-sized day bed. It

quickly becomes apparent onboard that this is a very social boat designed to enjoy the world around you rather than being forced down below.

A spacious galley provides large working area, large tabletops plus wide windows with brilliant visibility and ventilation.

Accommodating up to 8-10 people overnight, there are two substantial double cabins with two additional 3/4 double V-berths, complemented by a generous shared head / shower.





End View

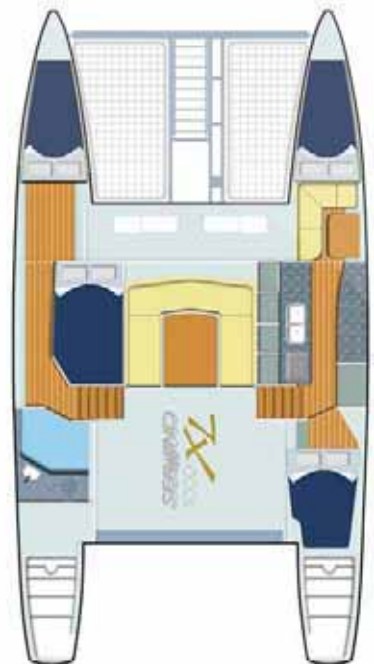

Aft Bathroom Layout

Seawind 1000XL

SPECIFICATIONS

Overall Length	35'5" / 10.85m
Waterline Length	34'1" / 10.4m
Beam	19'5" / 5.9m
Draft	3'3" / 1.0m
Displacement	12,100lbs / 5.5 tonnes
Underwing Clearance	2'5" / 0.75m
Steering Twin Helms	Cable Steering
Engines	2 x 9.9hp Yamaha Outboards
Freshwater	105 US Gallons / 400 litres
Fuel	26 US Gallons / 100 litres
Holding Tanks	23 US Gallons / 90 litres

CONTACT



T: +61 (0)2 4285 9985 F: +61 (0)2 4285 9984
 25 York Place, Russell Vale NSW 2517
info@seawindcats.com www.seawindcats.com

AGENT

Contact Wayne Woodward of Yachtshare on
 0438 722 888 for Syndication on Moreton Bay,
 Brisbane

or,

Call Andrew Crawford of Seawind Catamarans for
 out right purchase on 0402 345 245

SEAWIND 1000 XL



Family fun guaranteed!

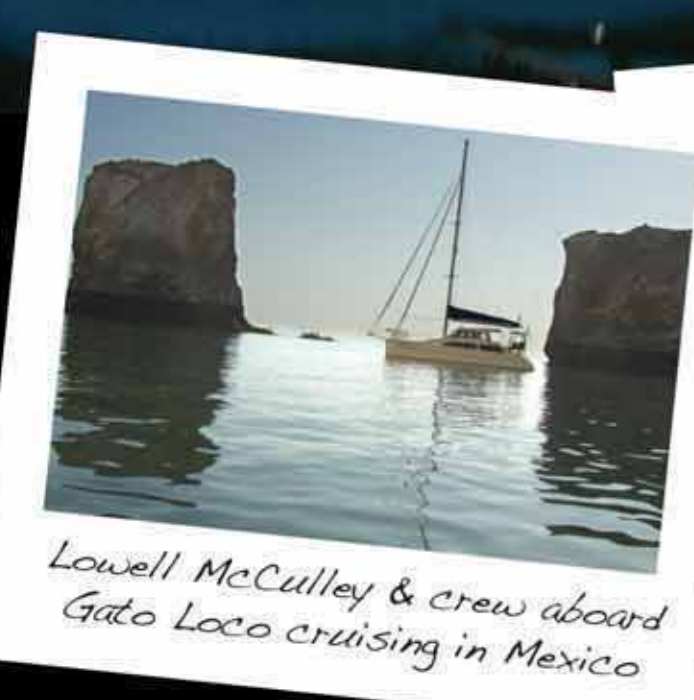

Lowell McCulley & crew aboard Gato Loco cruising in Mexico



Seawind 1000 Wandering Star in Lake Tahoe, USA

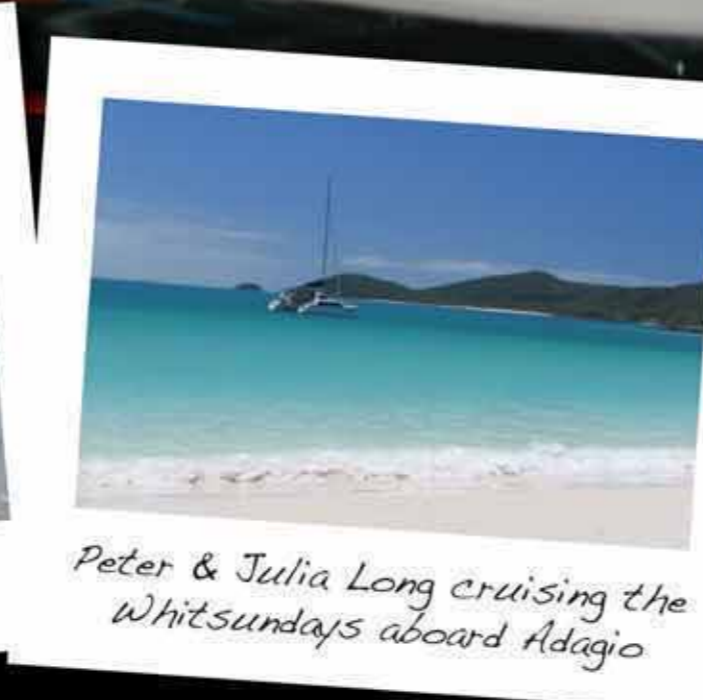

Peter & Julia Long cruising the Whitsundays aboard Adagio

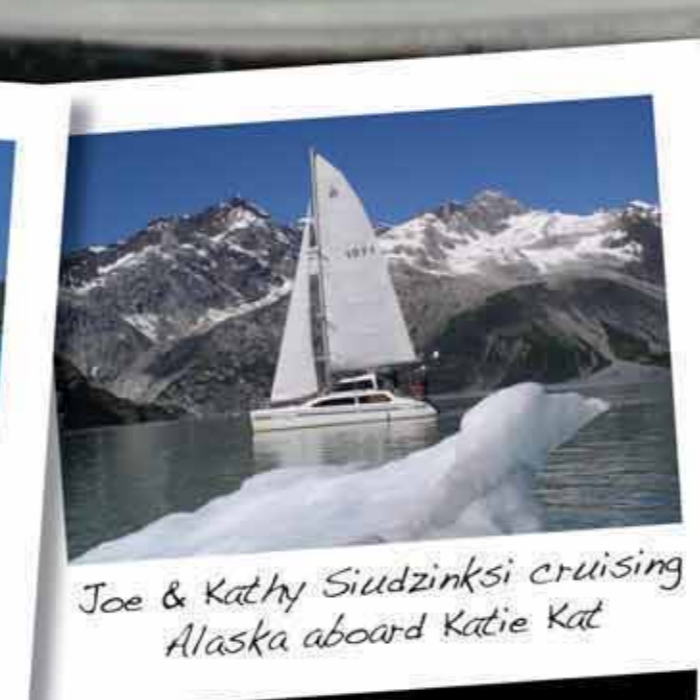

Joe & Kathy Siudzinski cruising Alaska aboard Katie Kat



Barry Kepert cruising the Kimberly aboard Damirri 2

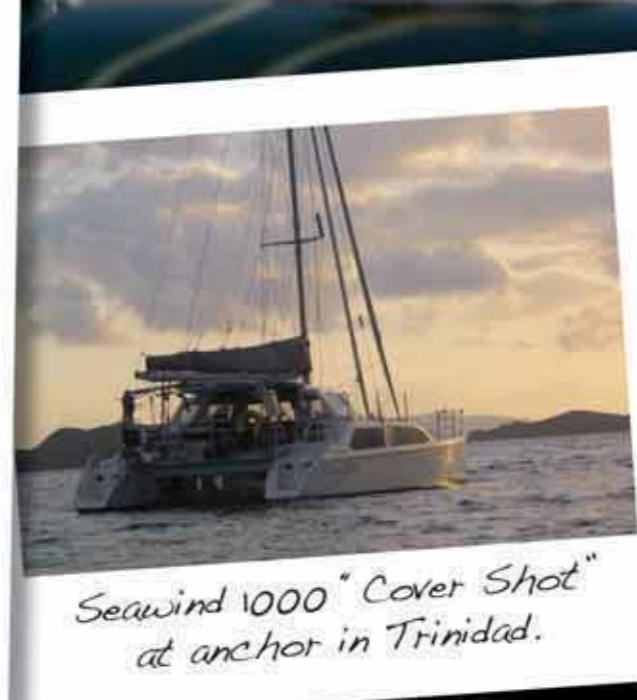

Seawind 1000 "Cover Shot" at anchor in Trinidad.



Russell Wallace cruising Tasmania aboard Amazing Grace on his circumnavigation of Australia